

Directions to East Midlands Conference Centre

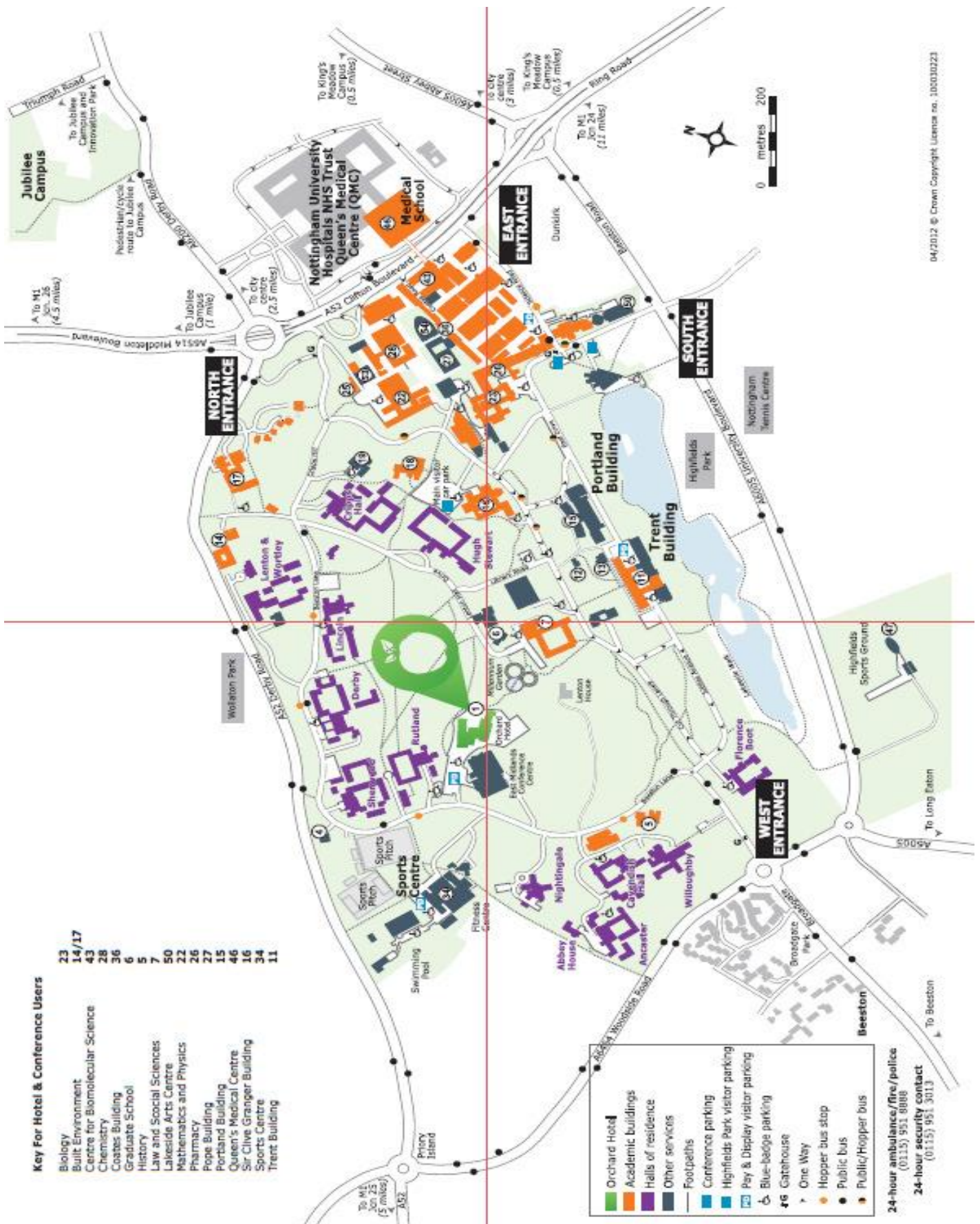

Getting to the conference

The conference will be held at the East Midlands Conference Centre, Beeston Lane, University Park, Nottingham NG7 2RJ. All accommodation is booked at the Orchard Hotel which is next door to the conference centre.

For more information on the venue or how to get there visit www.nottinghamconferences.co.uk/emcc or call them on 0115 876 0851.

Travelling by car?

The conference centre and hotel has plenty of free parking, including a number of disabled spaces. For satellite navigations systems please use postcode **NG7 2QL**.

Directions from the M1 North to University Park:

1. Leave the M1 motorway at junction 26
2. Follow the A610 signposted to Nottingham
3. After approximately 2.5 miles turn right at the lights onto the A6514 Nottingham ring road (Western Boulevard)
4. Follow the A6514 to Middleton Boulevard and then take the slip road towards the Queen's Medical Centre roundabout
5. At the roundabout, take the third exit onto the A52, Derby Road
6. At the next roundabout (Toby Carvery) turn left onto the A6464 Woodside Road
7. At the next roundabout, turn left to enter the University Park's West Entrance.

Directions from the M1 South to University Park:

1. Leave the M1 motorway at junction 25
2. Follow the A52 signposted to Nottingham
3. After approximately 4.4 miles turn right at the roundabout (Toby Carvery) onto the A6464 Woodside Road
4. Turn left at the next roundabout to enter the University Park's West Entrance.

There are four entrances to the University Park, you can use any one. Once you arrive at University Park, follow the signs to the East Midlands Conference Centre and the Orchard Hotel on Beeston Lane. Barriers and security are sometimes in use.

Parking at the conference centre is free. If you park on the main road or university campus you will need to collect a parking permit from reception.

Travelling by train?

Nottingham is the nearest main line station with plenty of taxis and better facilities and accessibility. The taxi fare from Nottingham is approximately £9 each way.

You can also get a train to Beeston station. This is a **small** station with few taxis and limited facilities. To book a taxi call 0115 9700 700 or the hotel reception on 0115 876 0851. A taxi from Beeston is approximately £6.

To plan your journey go to www.nationalrail.co.uk or call 03457 484 950. Remember to book your tickets early to get cheaper prices. If you have a disability or need help go to www.disabledpersons-railcard.co.uk to arrange support or see if you are eligible for a discounted rail card.

Travelling by bus?

University Park is on major bus routes from Nottingham town centre. Go to www.trentbarton.co.uk or call 01773 712265 for more information.

Travelling by plane?

The nearest airport is East Midlands Airport which is approximately 14 miles from the conference centre. To arrange a taxi contact Arrow Cars on 01332 814 000. The taxi fare is about £35 each way. For more information go to www.eastmidlandsairport.com